

Threaded Nozzles – Hollow Cone Series HW

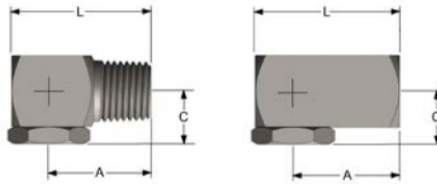
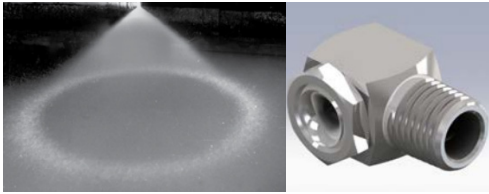

Model male	Dim. A (mm)	Dim. L (mm)	Dim. C (mm)	Model female	Dim. A (mm)	Dim. L (mm)	Dim. C (mm)
1/8HW	18	25	10	1/8FHW	18	25	10
1/4HW	24	25	13	1/4FHW	24	25	13
3/8HW	25	35	14	3/8FHW	25	35	14
1/2HW	35	48	19	1/2FHW	35	48	19
3/4HW	40	57	22	3/4FHW	40	57	22

SPRAY CHARACTERISTICS:

A hollow cone spray pattern, emerging at right angles to the centerline of the pipe connection. The standard included angle of the spray cone is 120° at 0.7 bar. At low pressures hollow cone nozzles produce medium size, uniform droplets. At higher pressures finer droplets are produced.

CONSTRUCTION:

The models listed are machined from bar stock, and are two piece construction. Standard materials are brass, 303 stainless steel and 316 stainless steel. Some models available in other materials.

TYPICAL APPLICATIONS:

- Air and Gas Washing
- Aerating, Rinsing and Humidifying
- Industrial Washers and Spray Ponds
- Cooling Tunnels
- Roof Cooling
- Degreasing
- Dust Suppression
- Metal Treatment

Model Number		Thread BSPT	MAX. FREE PASSAGE (mm)	CAPACITY (L/min) AT VARIOUS PRESSURES (bar)												Spray Angle @			
female	female			0.3 bar	0.5 bar	0.7 bar	1 bar	1.5 bar	2 bar	3 bar	4 bar	5 bar	6 bar	8 bar	0.7 bar	1.5 bar	3 bar	6 bar	
1/8FH1W	1/8H1W	1/8"	1.4	--	--	--	0.46	0.56	0.64	0.79	0.91	1.02	1.12	1.29	--	115°	107°	95°	
1/8FH2W	1/8H2W	1/8"	1.96	--	0.64	0.76	0.91	1.12	1.29	1.58	1.82	2.04	2.23	2.58	120°	117°	105°	97°	
1/8FH3W	1/8H3W	1/8"	2.36	--	0.97	1.14	1.37	1.67	1.93	2.37	2.73	3.06	3.3	3.9	120°	116°	109°	92°	
1/8FH5W	1/8H5W	1/8"	2.77	--	1.61	1.91	2.28	2.79	3.2	3.9	4.6	5.1	5.6	6.4	120°	116°	107°	90°	
1/4FH1W	1/4H1W	1/4"	1.4	--	0.32	0.38	0.46	0.56	0.64	0.79	0.91	1.02	1.12	1.29	120°	110°	102°	90°	
1/4FH2W	1/4H2W	1/4"	1.96	--	0.64	0.76	0.91	1.12	1.29	1.58	1.82	2.04	2.23	2.58	120°	110°	105°	92°	
1/4FH3W	1/4H3W	1/4"	2.36	--	0.97	1.14	1.37	1.67	1.93	2.37	2.73	3.06	3.3	3.9	120°	114°	104°	90°	
1/4FH5W	1/4H5W	1/4"	2.77	--	1.61	1.91	2.28	2.79	3.2	3.9	4.6	5.1	5.6	6.4	120°	113°	107°	98°	
1/4FH7.5W	1/4H7.5W	1/4"	4.01	1.87	2.42	2.86	3.4	4.2	4.8	5.9	6.8	7.6	8.4	9.7	120°	115°	110°	92°	
1/4FH10W	1/4H10W	1/4"	4.32	2.5	3.2	3.8	4.6	5.6	6.4	7.9	9.1	10.2	11.2	12.9	120°	115°	110°	93°	
1/4FH12.5W	1/4H12.5W	1/4"	4.78	3.12	4	4.8	5.7	7	8.1	9.9	11.4	12.7	14	16.1	120°	118°	110°	94°	
1/4FH15W	1/4H15W	1/4"	5.11	3.7	4.8	5.7	6.8	8.4	9.7	11.8	13.7	15.3	16.7	19.3	120°	115°	108°	92°	
3/8FH5W	3/8H5W	3/8"	2.77	1.25	1.61	1.91	2.28	2.79	3.2	3.9	4.6	5.1	5.6	6.4	120°	117°	107°	99°	
3/8FH7.5W	3/8H7.5W	3/8"	4.01	1.87	2.42	2.86	3.4	4.2	4.8	5.9	6.8	7.6	8.4	9.7	120°	113°	110°	93°	
3/8FH10W	3/8H10W	3/8"	4.32	2.5	3.2	3.8	4.6	5.6	6.4	7.9	9.1	10.2	11.2	12.9	120°	115°	110°	93°	
3/8FH12.5W	3/8H12.5W	3/8"	4.78	3.12	4	4.8	5.7	7	8.1	9.9	11.4	12.7	14	16.1	120°	115°	108°	94°	
3/8FH15W	3/8H15W	3/8"	5.11	3.7	4.8	5.7	6.8	8.4	9.7	11.8	13.7	15.3	16.7	19.3	120°	110°	105°	90°	
3/8FH20W	3/8H20W	3/8"	5.94	5	6.4	7.6	9.1	11.2	12.9	15.8	18.2	20.4	22.3	25.8	120°	118°	116°	110°	
3/8FH25W	3/8H25W	3/8"	6.73	6.2	8.1	9.5	11.4	14	16.1	19.7	22.8	25.5	27.9	32	120°	117°	115°	110°	
3/8FH30W	3/8H30W	3/8"	7.11	7.5	9.7	11.4	13.7	16.7	19.3	23.7	27.3	30.6	33	39	120°	115°	110°	102°	
1/2FH50W	1/2H50W	1/2"	9.09	12.5	16.1	19.1	22.8	27.9	32	39	46	51	56	64	120°	115°	108°	103°	