

# Other Types of Nozzles and Accessories – Ruby Orifice Nozzles



### TYPICAL APPLICATIONS:

These nozzles are engineered specifically for the pulp and paper industry. The nozzles are designed to give a laminar stream of liquid at higher pressures with much higher wear resistance than the equivalent nozzles made of stainless steel.

**WT Series Spray Nozzles.** These trim type of spray nozzles provide a consistent solid stream of water at various pressures up to 135 bar.

### CONSTRUCTION:

The nozzles consist of a ruby insert pressed into a 317SS housing.

| Model Number | MAX. FREE PASSAGE (mm) | CAPACITY (L/min) AT VARIOUS PRESSURES (bar) |        |        |        |        |        |        |        |         |         |
|--------------|------------------------|---|--------|--------|--------|--------|--------|--------|--------|---------|---------|
|              |                        | 6 bar                                       | 12 bar | 20 bar | 25 bar | 35 bar | 40 bar | 55 bar | 70 bar | 100 bar | 135 bar |
| WT32         | 0.81                   | 0.74  | 1.02   | 1.34   | 1.48   | 1.75   | 1.86   | 2.19   | 2.48   | 2.98    | 3.45    |
| WT35         | 0.89                   | 0.88  | 1.27   | 1.64   | 1.84   | 2.17   | 2.31   | 2.72   | 3.05   | 3.65    | 4.23    |
| WT40         | 1.02                   | 1.17  | 1.66   | 2.16   | 2.38   | 2.82   | 3.02   | 3.55   | 4      | 4.8     | 5.54    |
| WT45         | 1.14                   | 1.41  | 1.98   | 2.53   | 2.85   | 3.36   | 3.61   | 4.23   | 4.77   | 5.7     | 6.63    |



### WN Series Spray Nozzles.

These trim type of spray nozzles provide a consistent solid stream of water at various pressures up to 55 bar. They are available in both the BEX WF disc style and the BEX WN threaded style.

Standard body material is 316SS.

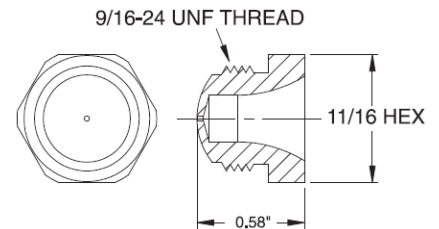

| Model Number | MAX. FREE PASSAGE (mm) | CAPACITY (L/min) AT VARIOUS PRESSURES (bar) |       |       |       |       |        |        |        |        |
|--------------|------------------------|---|-------|-------|-------|-------|--------|--------|--------|--------|
|              |                        | 1.5 bar                                     | 3 bar | 4 bar | 5 bar | 7 bar | 15 bar | 20 bar | 40 bar | 60 bar |
| WN32         | 0.81                   | 0.4   | 0.5   | 0.6   | 0.7   | 0.8   | 1.1    | 1.3    | 1.9    | 2.3    |
| WN35         | 0.89                   | 0.4   | 0.6   | 0.7   | 0.8   | 1     | 1.4    | 1.6    | 2.3    | 2.8    |
| WN40         | 1.02                   | 0.6   | 0.8   | 1     | 1.1   | 1.3   | 1.8    | 2.2    | 3      | 3.7    |
| WN45         | 1.14                   | 0.7   | 1     | 1.2   | 1.3   | 1.5   | 2.2    | 2.5    | 3.6    | 4.4    |



### WF Series Spray Nozzles.

These trim type of spray nozzles provide a consistent solid stream of water at various pressures up to 55 bar. They are available in both the BEX WF disc style and the BEX WN threaded style.

Standard body material is 317SS.

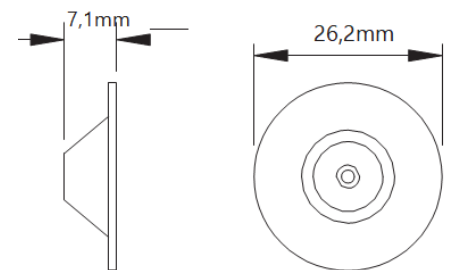

| Model Number | MAX. FREE PASSAGE (mm) | CAPACITY (L/min) AT VARIOUS PRESSURES (bar) |       |       |       |       |        |        |        |        |
|--------------|------------------------|---|-------|-------|-------|-------|--------|--------|--------|--------|
|              |                        | 1.5 bar                                     | 3 bar | 4 bar | 5 bar | 7 bar | 15 bar | 20 bar | 40 bar | 60 bar |
| WF32         | 0.81                   | 0.4   | 0.5   | 0.6   | 0.7   | 0.8   | 1.1    | 1.3    | 1.9    | 2.3    |
| WF35         | 0.89                   | 0.4   | 0.6   | 0.7   | 0.8   | 1     | 1.4    | 1.6    | 2.3    | 2.8    |
| WF40         | 1.02                   | 0.6   | 0.8   | 1     | 1.1   | 1.3   | 1.8    | 2.2    | 3      | 3.7    |
| WF45         | 1.14                   | 0.7   | 1     | 1.2   | 1.3   | 1.5   | 2.2    | 2.5    | 3.6    | 4.4    |